

APS 51/61/71

Pompe a membrana ad alta pressione
High pressure diaphragm pumps
Pompes a membrane a haute pression
Bombas con membrana de alta presión
Hochdruck-membranpumpen

VERSIONI STANDARD — STANDARD VERSIONS
VERSIONS STANDARD — VERSIONES ESTÁNDAR
STANDARD AUSFÜHRUNG

- Albero passante 1" 3/8 M - 1" 3/8 M
- Throughshaft 1" 3/8 M 1" 3/8 M
- Arbre traversant 1" 3/8 M 1" 3/8 M
- Cigüeñal pasante 1" 3/8 M 1" 3/8 M
- Durchgangswelle 1" 3/8 Zapfen 1" 3/8 Zapfen

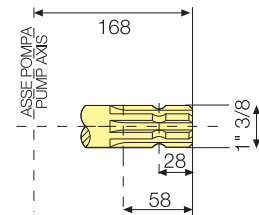
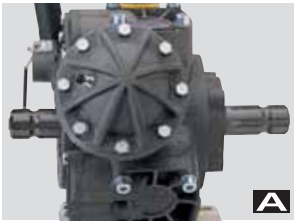

- Albero non passante 6 fori 1" 3/8 F
- Six holes bare pump shaft
- Arbre non traversant percé 6 trous
- Cigüeñal no pasante seis agujeros 1" 3/8 hembra
- 6-Loch-Welle

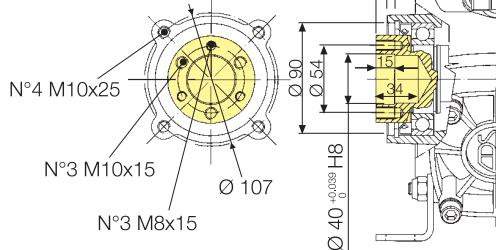

- Albero passante 1" 3/8 M - 6 fori 1" 3/8 F
- Throughshaft 1" 3/8 M - Six-Holes 1" 3/8 F
- Arbre traversant 1" 3/8 M - 1" 3/8 F percé 6 trous
- Cigüeñal pasante 1" 3/8 M - 1" 3/8 hembra seis agujeros
- Durchgangswelle 1" 3/8 Zapfen - 1" 3/8 mit Bohrung mit 6 Löchern

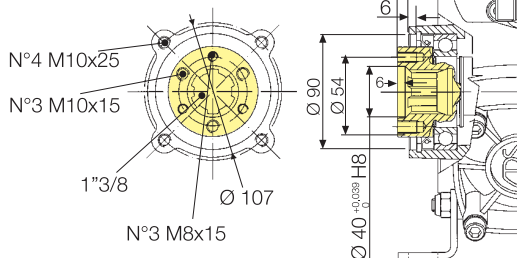

VERSIONI DERIVATE DA STANDARD (B) — VERSIONS ADAPTED FROM THE
STANDARD (B) — VERSIONS DÉRIVÉES DE VERSION STANDARD (B)
VERSIONES DERIVADAS DE LA ESTÁNDAR (B)
VON DER STANDARD AUSFÜHRUNG (B) ABGELEITETE MODELLE

- Flangiata
- Flanged
- Bridée
- Con brida
- Geflanscht



- *Le dimensioni variano in base al tipo di applicazione.
- *Dimensions vary depending on the type of application.
- *Les dimensions varient selon le type d'application.
- *Las dimensiones varían en función del tipo de aplicación.
- *Die Abmessungen ändern sich in Abhängigkeit von der Art der Anbringung.

VERSIONI DERIVATE DA STANDARD (B-C) — VERSIONS ADAPTED FROM THE
STANDARD (B-C) — VERSIONS DÉRIVÉES DE VERSION STANDARD (B-C)
VERSIONES DERIVADAS DE LA ESTÁNDAR (B-C)
VON DER STANDARD AUSFÜHRUNG (B-C) ABGELEITETE MODELLE

- Riduttore di giri 1:4,33
- Gearbox reduction 1:4,33
- Réducteur 1:4,33
- Reductor para motor 1:4,33
- Untersetzungsgetriebe 1:4,33

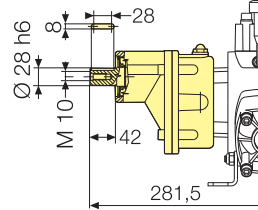

- Puleggia
- Pulley
- Poulie
- Polea
- Keilriemenscheibe

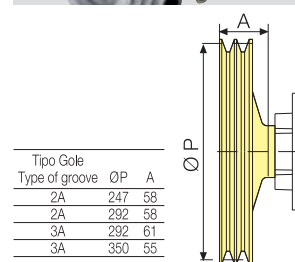

- Cardano 1" 3/8
- 1" 3/8 male PTO
- Cardan mâle 1" 3/8
- Cigüeñal estriada 1" 3/8
- Für Kardan 1" 3/8

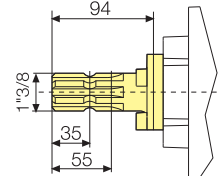

- Attacco rapido 1" 3/8
- Quick coupling 1" 3/8 spl. (female 1" 3/8 PTO)
- Accouplement 1" 3/8 femelle
- Enganche rápido 1" 3/8
- Schnellkupplung 1" 3/8



VERSIONI DERIVATE DA STANDARD (C) — VERSIONS ADAPTED FROM THE STANDARD (C) — VERSIONS DÉRIVÉES DE VERSION STANDARD (C)
VERSIONES DERIVADAS DE LA ESTÁNDAR (C)
VON DER STANDARDAUSFÜHRUNG (C) ABGELEITETE MODELLE

- Flangiata a moltiplicatore
- Coupled to overgearbox
- Flasquée à multiplicateur
- Para cople a multiplicador
- Angeflanscht an Untersetzungsgetriebe



VERSIONI DERIVATE DA STANDARD (B) — VERSIONS ADAPTED FROM THE STANDARD (B) — VERSIONS DÉRIVÉES DE VERSION STANDARD (B)
VERSIONES DERIVADAS DE LA ESTÁNDAR (B)
VON DER STANDARDAUSFÜHRUNG (B) ABGELEITETE MODELLE

- Flangiata a motore idraulico
- Coupled to hydraulic motor
- Flasquée à moteur hydraulique
- Para cople a motor hidráulico
- Angeflanscht an Hydraulischen Motor

